

Koi

Design
Giancarlo Alci

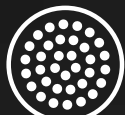

LED



indoor



outdoor

ACCESSORI

Accessories / Accessoires

PAG. 158



Adatto anche ad uso esterno.

Driver 220-240V integrato e Led di ultima generazione.

Corpo e tappo in alluminio primario pressofuso EN-AB46100; elevata resistenza all'ossidazione grazie al trattamento di passivazione a base di zirconio e alla verniciatura con resine poliestere stabilizzata ai raggi UV.

Diffusore in vetro temprato effetto satinato. Guarnizione in silicone. Sistema di chiusura tramite viti imperdibili a scomparsa, con cava esagonale. Bulloneria in acciaio A4 o AISI 316L. Predisposto per doppio ingresso alimentazione.

LED 4000K (N), 3000K (3) o 2700K (2). Alimentazione diretta 220-240V.

Nessun rischio fotobiologico, RGO gruppo di rischio esente (EN62471).

ENG Suitable for indoor and outdoor use.

Integrated driver 220-240V and the latest generation of Led.

Body and cover made of EN-AB46100 die-cast aluminium primary alloy; highly resistant to oxidization thanks to the zirconium-based passivation treatment and UV stabilized polyester resin coating.

Tempered glass diffuser with frosted effect. Silicone gaskets.

Closing system by means of retractable captive hex screws. Double cable entry at the back.

LED 4000K (N), 3000K (3) o 2700K (2). Integral ballast 220-240V.

No risk of photobiological damage, RGO group (EN62471).

FRA Egalement adapté à l'usage à l'extérieur.

Alimentation intégrée 220 - 240V et Led de dernière génération.

Corps et couverture en aluminium primaire injecté EN-AB46100; haute résistance à l'oxydation grâce au traitement de passivation à base de zirconium et laquage poudre à base de résines polyesters, fixées au rayon UV. Diffuseur en verre trempé effet satiné. Joints en silicone.

Visserie en acier inox type A4 ou AISI 316L. Fermeture vis sans tête à six pans creux. Possibilité alimentation double entrée.

LED 4000K (N), 3000K (3) ou 2700K (2) (blanche chaud). Alimentation intégrée 220-240.

Pas de risque photobiologique, RGO groupe (EN62471).

Koi 110



Koi 120



IP66
Outdoor e
waterproof



220-240 V
Alimentazione
diretta

Integral ballast
Alimentation intégrée

Koi 220



**Installazione
rapida**
Quick installation
Rapide installation



Anni di garanzia
sul circuito LED

Direttamente a parete.
Surface mounting.
En saillie.

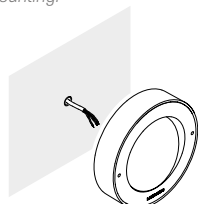

Con scatolette standard.
Surface mounting on recess box.
En saillie sur boîte d'encastrement.

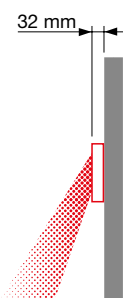
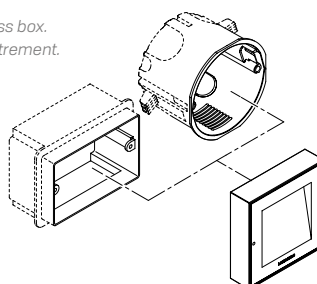

Koi

Koi 110

IP 66 IK 10 20J xx9 CE

LED	W	LM	REAL LM	COL.	CODE *	* LED COLOUR
A++					LL121000□	N 4000K
	6	750	375	⊕ 220-240 V	LL121001□	3 3000K, lm -5%
					LL121002□	2 2700K, lm -5%
					LL121003□	

POSITION

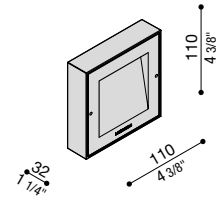

Koi 120

IP 66 IK 10 20J xx9 CE

LED	W	LM	REAL LM	COL.	CODE *	* LED COLOUR
A++					LL121004□	N 4000K
	6	750	375	⊕ 220-240 V	LL121005□	3 3000K, lm -5%
					LL121006□	2 2700K, lm -5%
					LL121007□	

POSITION

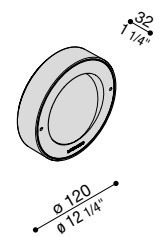

Koi 220

IP 66 IK 10 20J xx9 CE

LED	W	LM	REAL LM	COL.	CODE *	* LED COLOUR
A++					LL121008□	N 4000K
	9	1300	650	⊕ 220-240 V	LL121009□	3 3000K, lm -5%
					LL121010□	2 2700K, lm -5%
					LL121011□	

POSITION

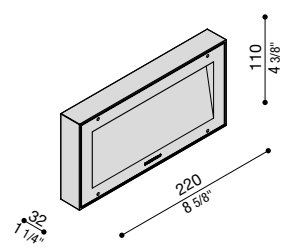

Finishing

	Bianco White Blanc		Grigio antracite Grey anthracite Gris anthracite
	Grigio High Tech Grey High Tech Gris High Tech		Corten Corten Corten

* Led colour

- N 4000K
- 3 3000K, lm -5%
- 2 2700K, lm -5%

Completa il codice sostituendo al quadrato rosso la lettera o il numero corrispondente alla temperatura colore scelta.

Complete the code by replacing the red box with the letter or number corresponding to the selected colour temperature.

Compléter le code en remplaçant le carré rouge par la lettre ou le numéro correspondant à la sélection de température couleur.

Alimentazione diretta

Integral ballast
Alimentation intégrée

⊕ 220-240 V

Alimentatore escluso

Ballast not included
Sans alimentation



Scatola Incasso Standard 503

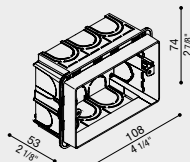

Recess Box 503

Armature à encastrer standard 503

COL. CODE

LB11660

ACCESSORI

Accessories / Accessoires



Colori disponibili.
Available colours.
Couleurs disponibles.



Koi 220

Koi



Koi 110



Koi 120



Koi 220



Koi 110



Koi 120



Koi 220

Koi 110 Post

Design
Giancarlo Alci



LED



outdoor



Adatto anche ad uso esterno.

Driver 220-240V integrato e Led di ultima generazione.

Corpo e tappo in alluminio pressofuso; elevata resistenza all'ossidazione grazie al trattamento di passivazione a base di zirconio e alla verniciatura con resine poliestere stabilizzata ai raggi UV.

Diffusore in vetro temprato effetto satinato.

Guarnizione in silicone. Sistema di chiusura tramite viti imperdibili a scomparsa, con cava esagonale.

Bulloneria in acciaio A4 o AISI 316L. Predisposto per doppio ingresso alimentazione.

Palo da giardino. Corpo realizzato in metallo zincato a freddo, verniciato con resine poliestere stabilizzate ai raggi UV.

Bulloneria in acciaio inox A4. Idoneo per installazione a terra.

LED 4000K (N), 3000K (3) o 2700K (2). Alimentazione diretta 220-240V.

Nessun rischio fotobiologico, RGO gruppo di rischio esente (EN62471).

ENG Suitable for indoor and outdoor use.

Integrated driver 220-240V and the latest generation of Led.

Body and cover made of die-cast aluminium primary alloy; highly resistant to oxidation thanks to the zirconium-based passivation treatment and UV stabilized polyester resin coating.

Tempered glass diffuser with frosted effect.

Silicone gaskets.

A4 or AISI 316L stainless steel nuts and bolt.

Closing system by means of retractable captive hex screws. Double cable entry at the back.

Post for garden use. Made of cold galvanized metal, coated with UV-stabilised polyester resins. A4 stainless steel nuts and bolts. Suitable for outdoor use and ground application.

LED 4000K (N), 3000K (3) or 2700K (2). Integral ballast 220-240V.

No risk of photobiological damage, RGO group (EN62471).

FRA Egalement adapté à l'usage à l'extérieur.

Alimentation intégrée 220 - 240V et Led de dernière génération.

Corps et couverture en aluminium primaire injecté; haute résistance à l'oxydation grâce au traitement de passivation à base de zirconium et laquage poudre à base de résines polyester, fixées au rayon UV.

Diffuseur en verre trempé effet satiné.

Joints en silicone.

Visserie en acier inox type A4 ou AISI 316L.

Fermeture vis sans tête à six pans creux.

Possibilité alimentation double entrée.

Poteau de jardin. Corps réalisé en métal zingué à froid, peinture avec résines polyester stabilisées aux rayons UV. Boulonnerie en acier inox A4. Convient pour une utilisation au sol.

LED 4000K (N), 3000K (3) ou 2700K (2) (blanche chaud).

Alimentation intégrée 220-240. Pas de risque photobiologique, RGO groupe (EN62471).

Koi 110 Post H400



Koi 110 Post H600



IP66
Outdoor e
waterproof



220-240 V
Alimentazione
diretta

Integral ballast
Alimentation intégrée



Anni di garanzia
sul circuito LED

Koi 110 Post

Koi 110 Post H400

DIFF.
VETRO

POSITION

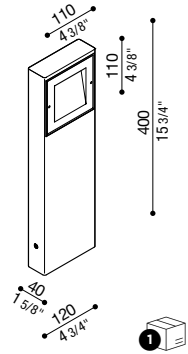

IP 66 IK 10 20J xx9 CE

LED	W	LM	REAL LM	COL.	CODE *	* LED COLOUR
A++					LL121016□	N 4000K
	6	750	375	⊕ 220-240 V	LL121017□	3 3000K, lm -5%
					LL121018□	2 2700K, lm -5%
					LL121019□	

Composto da Koi 110 + Palo H 400 mm

Consisting of Koi 110 + Post H 400 mm.

Composé de Koi 110 + Poteau 400 mm.

Koi 110 Post H600

DIFF.
VETRO

POSITION

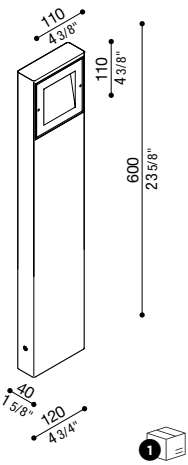

IP 66 IK 10 20J xx9 CE

LED	W	LM	REAL LM	COL.	CODE *	* LED COLOUR
A++					LL121012□	N 4000K
	6	750	375	⊕ 220-240 V	LL121013□	3 3000K, lm -5%
					LL121014□	2 2700K, lm -5%
					LL121015□	

Composto da Koi 110 + Palo H 600 mm.

Consisting of Koi 110 + Post H 600 mm.

Composé de Koi 110 + Poteau 600 mm.

Finishing

	Bianco White Blanc		Grigio antracite Grey anthracite Gris anthracite
	Grigio High Tech Grey High Tech Gris High Tech		Corten Corten Corten

* Led colour

N	4000K
3	3000K, lm -5%
2	2700K, lm -5%

Completa il codice sostituendo al quadrato rosso la lettera o il numero corrispondente alla temperatura colore scelta.

Complete the code by replacing the red box with the letter or number corresponding to the selected colour temperature.

Compléter le code en remplaçant le carré rouge par la lettre ou le numéro correspondant à la sélection de température couleur.

Alimentazione diretta

Integral ballast
Alimentation intégrée

✓ 220-240 V

Alimentatore escluso

Ballast not included
Sans alimentation





Koi 110 post H400