

CNC 35 2.0 Trimless Q

LT15852LN

Lombardo.

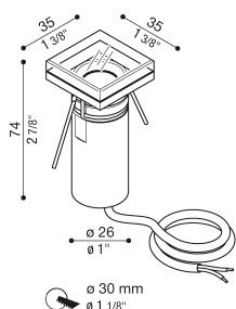

Informazioni tecniche:

Installazione:	Incasso terra
Materiale Corpo:	Alluminio - Acciaio verniciato
Trattamento:	Anodizzazione
Tipo di diffusore:	Vetro trasparente
Inclinazione ottica:	45°
Tipo lampada:	LED
Classe energetica:	G
Temperatura colore:	4000K
CRI:	>90
LB Factor:	L80B20 - 100.000h
Step MacAdam:	3
Rischio fotobiologico:	RG1
Potenza assorbita Watt:	2
Lumen:	150
Real Lumen:	140
Alimentazione:	⊗ esclusa
LED:	24V
Classe di isolamento:	⚡ CL.III
Cavo Alimentazione:	0,50 metri H05RN-F 2x0,75
Grado di protezione:	IP 67
Resistenza alla rottura:	IK 08 5J xx7
Marchi di Conformità:	CE UK ENEC
Caratteristiche aggiuntive:	↓ 500 ^{KG} MAX 111 ↑ 47°C MAX

Versione Honeycomb non disponibile con ottica D.

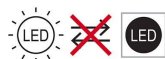
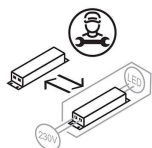

CNC 35 2.0 Trimless Q

Lombardo.

LT15852LN



Immagine di montaggio:

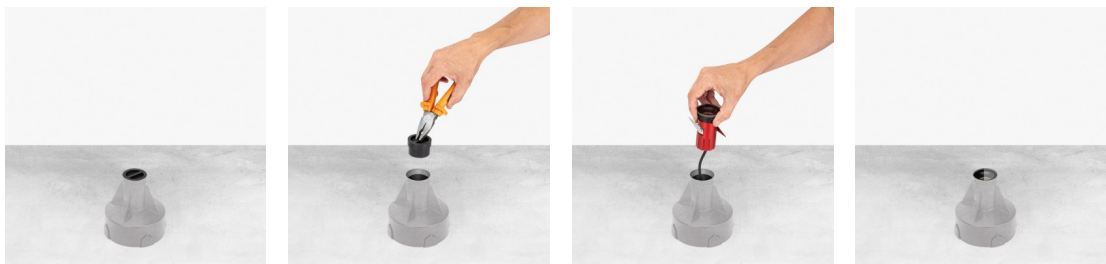

CNC 35 2.0 Trimless Q

Lombardo.

LT15852LN

Simulazioni illuminotecniche:

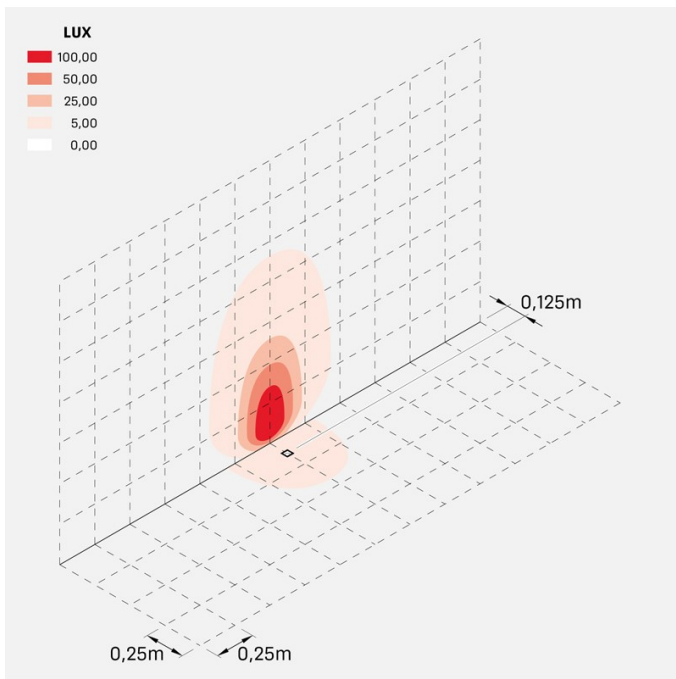

cnc_35q_simm_20_trimless_optic_D

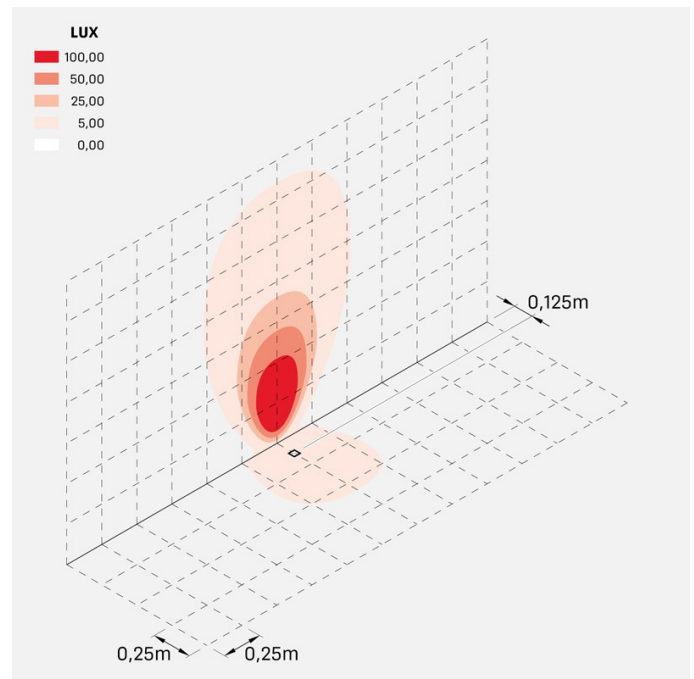

cnc_35q_simm_20_trimless_optic_L

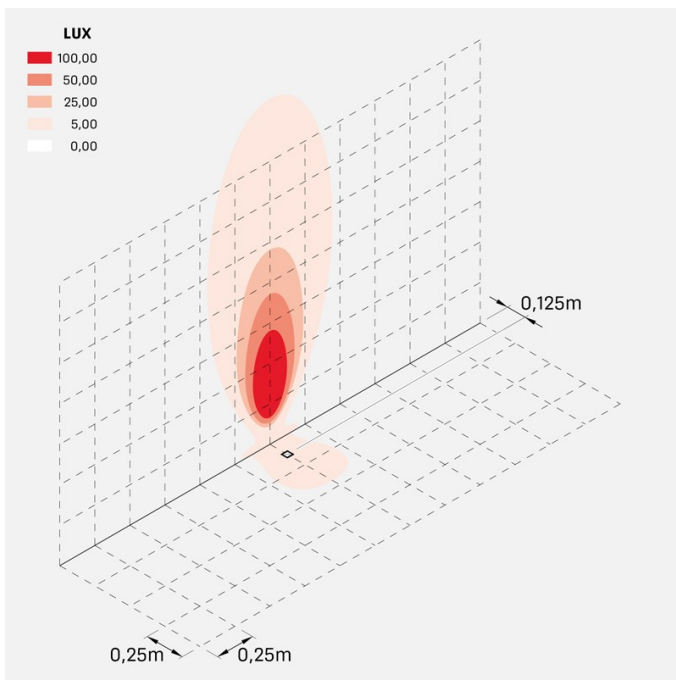

cnc_35q_simm_20_trimless_optic_M

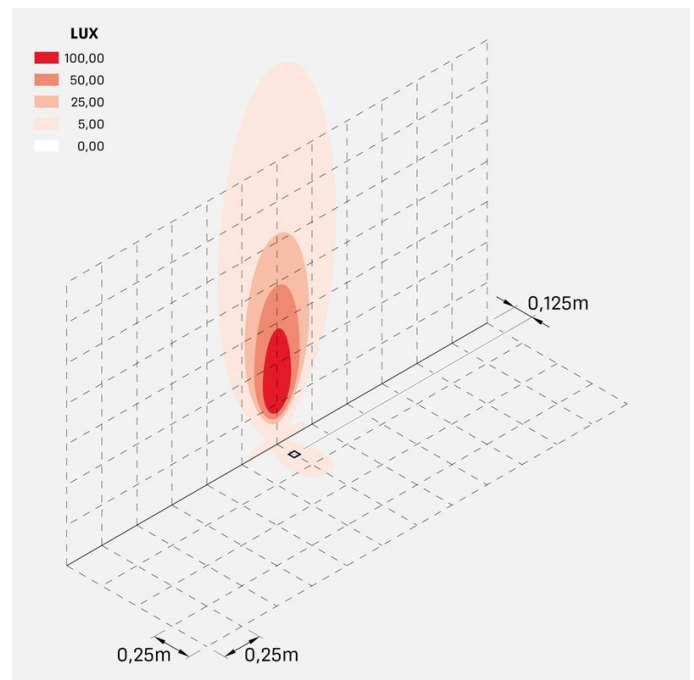

cnc_35q_simm_20_trimless_optic_S