

# CNC 35 2.0 T

LT15810KD3

**Lombardo.**

**NEW**

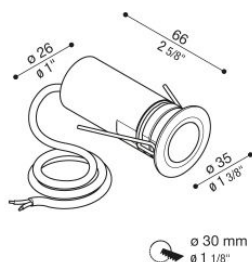

## Informazioni tecniche:

Installazione:	Incasso terra, Incasso parete, Incasso soffitto
Materiale Corpo:	Alluminio
Finitura:	Corten
Trattamento:	Anodizzazione
Tipo di diffusore:	Vetro trasparente
Inclinazione ottica:	Diff.
Tipo lampada:	LED
Classe energetica:	G
Temperatura colore:	3000K
CRI:	>90
LB Factor:	L80B20 - 100.000h
Step MacAdam:	3
Rischio fotobiologico:	RG1
Potenza assorbita Watt:	2
Lumen:	150
Real Lumen:	147
Alimentazione:	⊗ esclusa
LED:	24V
Classe di isolamento:	⊠ CL.III
Cavo Alimentazione:	0,50 metri H05RN-F 2x0,75
Grado di protezione:	<b>IP 67</b>
Resistenza alla rottura:	<b>IK 10 20J xx9</b>
Marchi di Conformità:	CE UK
Caratteristiche aggiuntive:	↓ 500 <sup>KG</sup> <sub>MAX</sub> Temp. max on diffuser 65°C

Versione Honeycomb non disponibile con ottica D.

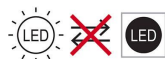

# CNC 35 2.0 T

LT15810KD3

Lombardo.

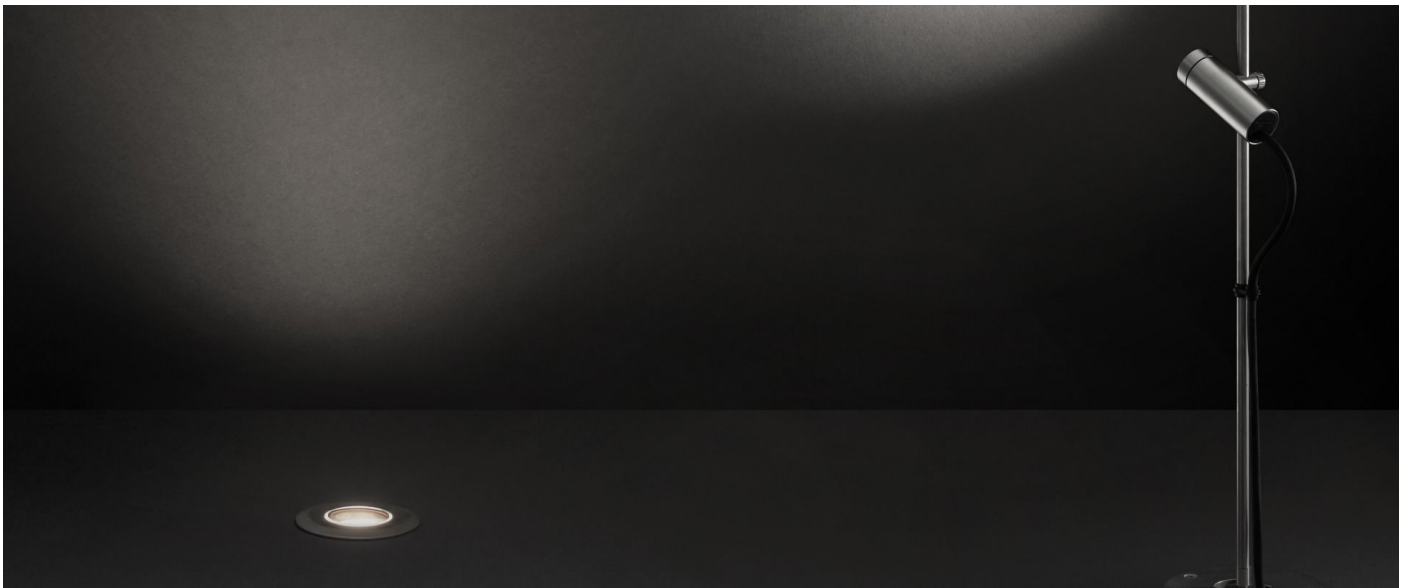

## Immagini di montaggio:

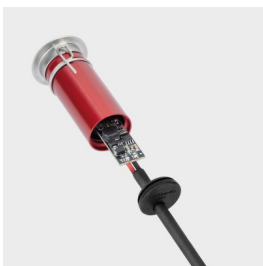

### Simulazioni illuminotecniche:

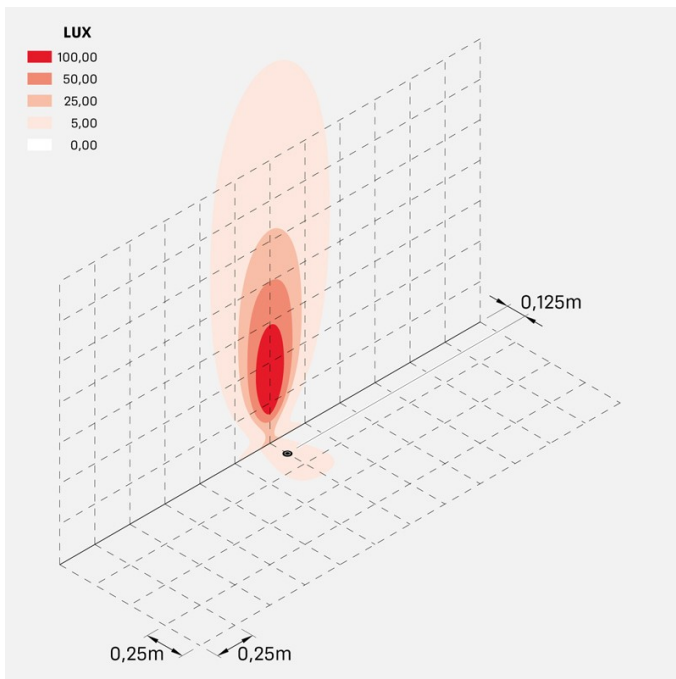

cnc\_35t\_20\_optic\_S

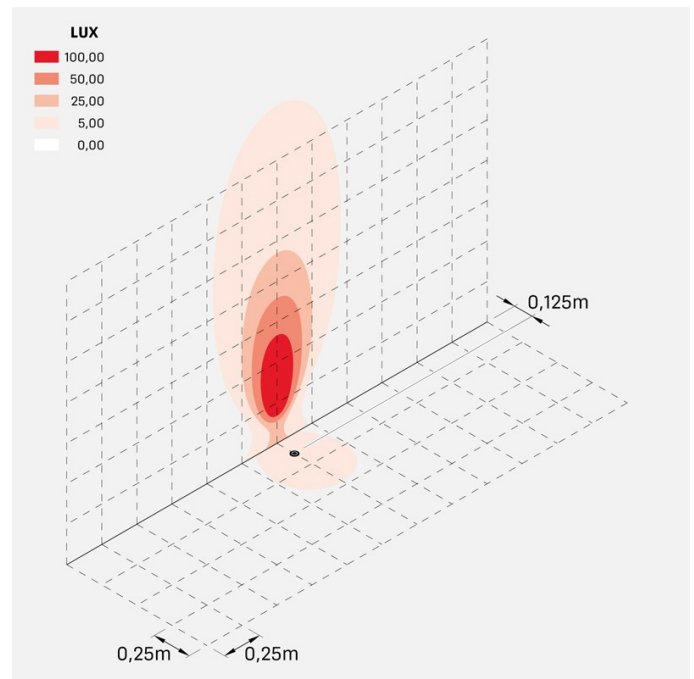

cnc\_35t\_20\_optic\_M

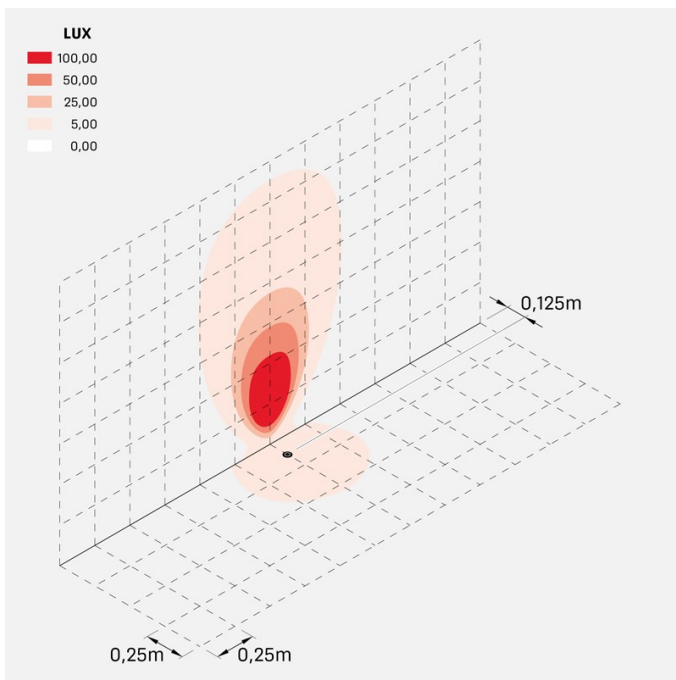

cnc\_35t\_20\_optic\_L

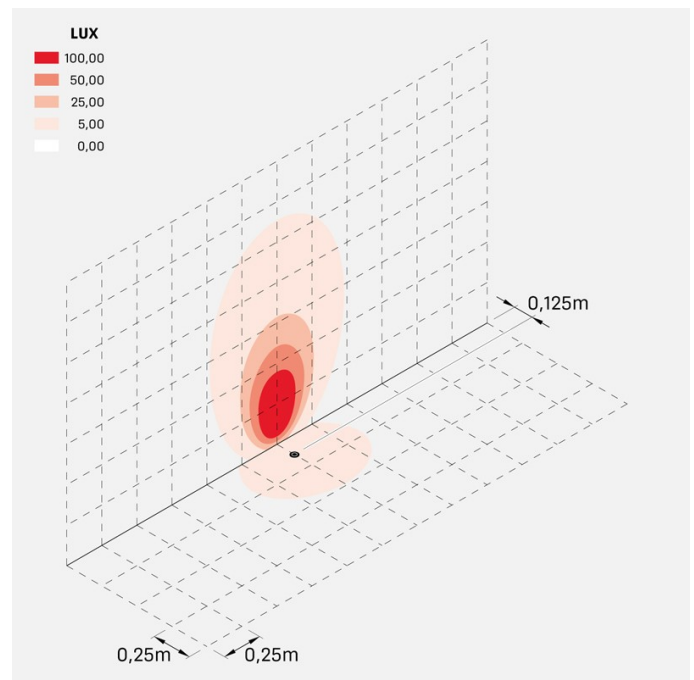

cnc\_35t\_20\_optic\_D