

# CNC 35

## CNC 35 Top S



DIFF.  
VETRO

IP 68 IK 10 20J xx9 CE UK CA 500 KG MAX 65° MAX

LED	W	LM	REAL LM		COL.	CODE *	* LED COLOUR
	2	180	12	⊕ × 500mA - 4,8V		LL107002□	<ul style="list-style-type: none"> <li>N 4000K</li> <li>3 3000K, lm -5%</li> <li>2 2700K, lm -5%</li> <li>B Blue</li> </ul>
	2	180	12	⊕ × 12/24V		LL107008□	

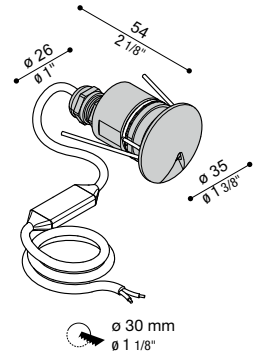

Versione ghiera Top con apertura a 45°. Temperatura massima rilevata sul vetro 65°C.

Version with Top retaining ring with 45° opening. Max. temperature measured on the glass 65°C.

Version avec virole Top ouverte à 45°. Température relevée sur le verre 65° C maxi.

## CNC 35 Top L



DIFF.  
VETRO

IP 68 IK 10 20J xx9 CE UK CA 500 KG MAX 65° MAX

LED	W	LM	REAL LM		COL.	CODE *	* LED COLOUR
	2	180	25	⊕ × 500mA - 4,8V		LL107003□	<ul style="list-style-type: none"> <li>N 4000K</li> <li>3 3000K, lm -5%</li> <li>2 2700K, lm -5%</li> <li>B Blue</li> </ul>
	2	180	25	⊕ × 12/24V		LL107009□	

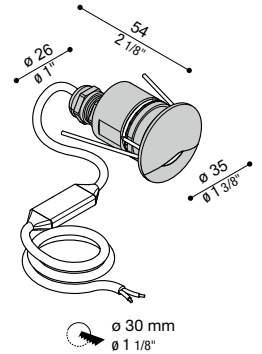

Versione ghiera top con apertura a 135°. Temperatura massima rilevata sul vetro 65°C.

Version with Top retaining ring with 135° opening. Max. temperature measured on the glass 65°C.

Version avec virole Top ouverte à 135°. Température relevée sur le verre 65° C maxi.

## CNC 35 Mask



DIFF.  
VETRO

IP 68 IK 10 20J xx9 CE UK CA 500 KG MAX 65° MAX

LED	W	LM	REAL LM		COL.	CODE *	* LED COLOUR
	2	180	21	⊕ × 500mA - 4,8V		LL107004□	<ul style="list-style-type: none"> <li>N 4000K</li> <li>3 3000K, lm -5%</li> <li>2 2700K, lm -5%</li> <li>B Blue</li> </ul>
	2	180	21	⊕ × 12/24V		LL107010□	

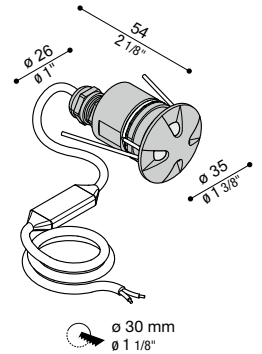

Versione ghiera Mask con 4 aperture da 35°. Temperatura massima rilevata sul vetro 65°C.

Version with Mask retaining ring with four 35° openings. Max. temperature measured on the glass 65°C.

Version avec virole Mask 4 ouvertures à 35°. Température relevée sur le verre 65° C maxi.